

ALLOTMENT 232 in DEV. NO. 292/D029/20/001
in the area named
ANGLE VALE
CT ---/----

PRELIMINARY

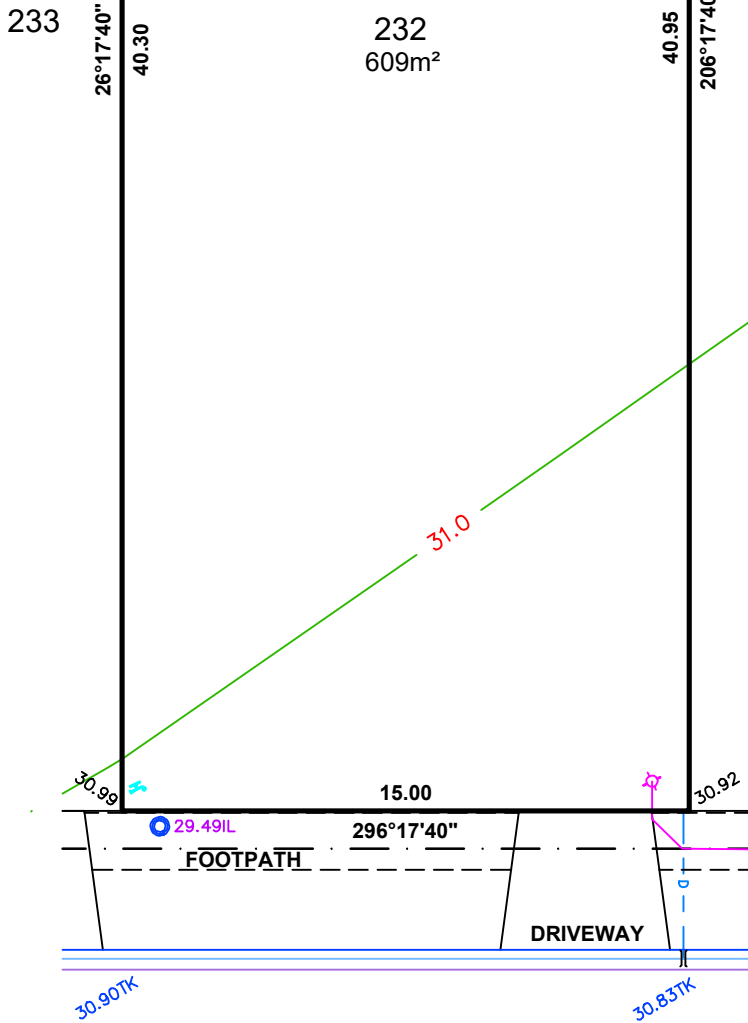
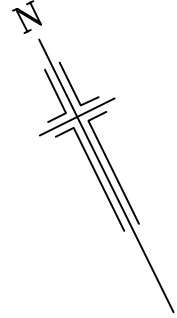

IMPORTANT
SERVICE AND DRIVEWAY LOCATIONS
ARE APPROXIMATE. ANY CHANGES WILL
BE AT THE PURCHASERS EXPENSE.
PURCHASER: _____
PURCHASER: _____
DATE: _____

DISCLAIMER:

Please note that this site plan is intended for visual purposes only, additional survey work will be required prior to commencing any design or construction on the site.

LEGEND

- 29.00IL INVERT LEVEL
- ⊕ ELECTRICAL LEAD IN
- ⊕ WATER METER
- ⊕ SEWER IP
- ▬ STOBIE POLE
- NBN PIT
- ▬ STORMWATER GRATING
- ⊕ SEWER MANHOLE
- ⊕ STORMWATER MANHOLE
- ★ LIGHT POLE
- ⊕ SAPN CONNECTION
- BOLLARD
- ♀ SIGN
- ⊕ STORMWATER CONNECTION
- - - FOOTPATH
- ▭ SIDE ENTRY PIT (SEP)
- - - COMMON SERVICE TRENCH
- - - DOMESTIC OUTLET (STORMWATER)
- ⊕ SEWER IO
- ⊕ POTABLE WATER CONNECTION

CANTINA ROAD



1:200

ALEXANDER SYMONDS
PH 8130 1666

DISCLAIMER: DATA SHOWN HEREON IS DESIGN INFORMATION AND SHOULD BE CONFIRMED
ORIGINAL SHEET SIZE A4

ALLOTMENT 233 in DEV. NO. 292/D029/20/001

**in the area named
ANGLE VALE**

CT ---/----

PRELIMINARY

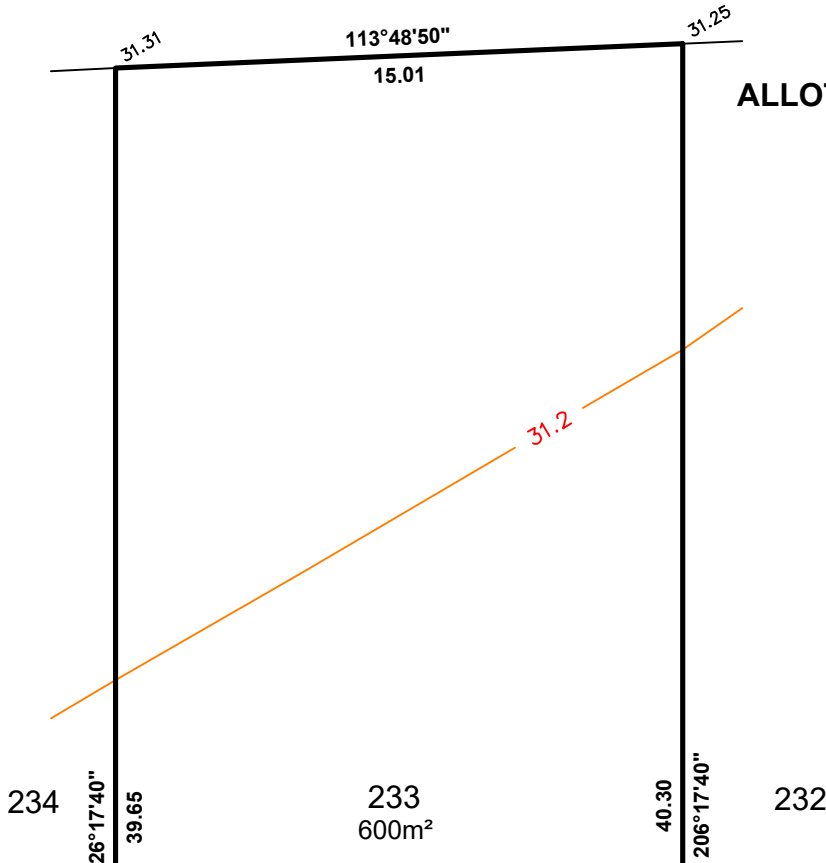
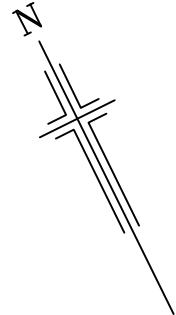

IMPORTANT
SERVICE AND DRIVEWAY LOCATIONS ARE APPROXIMATE. ANY CHANGES WILL BE AT THE PURCHASERS EXPENSE.
PURCHASER: _____
PURCHASER: _____
DATE: _____

DISCLAIMER:

Please note that this site plan is intended for visual purposes only, additional survey work will be required prior to commencing any design or construction on the site.

LEGEND

- 29.00IL INVERT LEVEL
- ⊕ ELECTRICAL LEAD IN
- ⊕ WATER METER
- ⊕ SEWER IP
- ▬ STOBIE POLE
- ▭ NBN PIT
- ▨ STORMWATER GRATING
- ⊙ SEWER MANHOLE
- ⊕ STORMWATER MANHOLE
- ★ LIGHT POLE
- ⊕ SAPN CONNECTION
- BOLLARD
- ♀ SIGN
- ⊕ STORMWATER CONNECTION
- - - FOOTPATH
- ▭ SIDE ENTRY PIT (SEP)
- - - COMMON SERVICE TRENCH
- - - DOMESTIC OUTLET (STORMWATER)
- ⊕ SEWER IO
- ⊕ POTABLE WATER CONNECTION

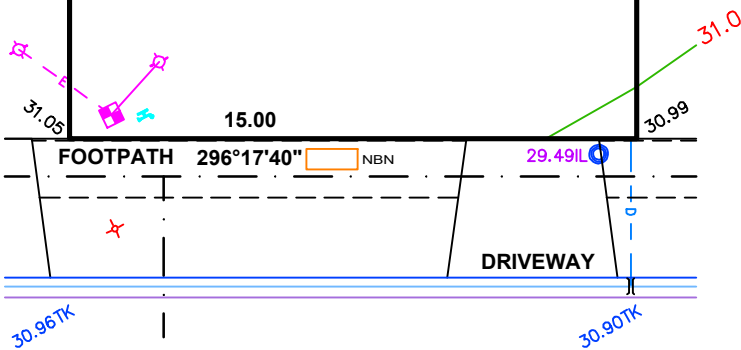

CANTINA ROAD



1:200

ALEXANDER SYMONDS
PH 8130 1666

DISCLAIMER: DATA SHOWN HEREON IS DESIGN INFORMATION AND SHOULD BE CONFIRMED
ORIGINAL SHEET SIZE A4

ALLOTMENT 234 in DEV. NO. 292/D029/20/001
in the area named
ANGLE VALE
 CT ---/----

PRELIMINARY

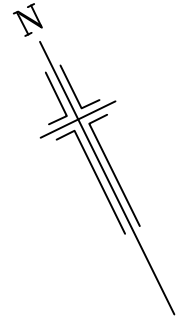

IMPORTANT
 SERVICE AND DRIVEWAY LOCATIONS
 ARE APPROXIMATE. ANY CHANGES WILL
 BE AT THE PURCHASERS EXPENSE.
 PURCHASER: _____
 PURCHASER: _____
 DATE: _____

DISCLAIMER:

Please note that this site plan is intended for visual purposes only, additional survey work will be required prior to commencing any design or construction on the site.

LEGEND

- 29.00IL INVERT LEVEL
- ELECTRICAL LEAD IN
- WATER METER
- SEWER IP
- STOBIE POLE
- NBN PIT
- STORMWATER GRATING
- SEWER MANHOLE
- STORMWATER MANHOLE
- LIGHT POLE
- SAPN CONNECTION
- BOLLARD
- SIGN
- STORMWATER CONNECTION
- FOOTPATH
- SIDE ENTRY PIT (SEP)
- COMMON SERVICE TRENCH
- - - - DOMESTIC OUTLET (STORMWATER)
- SEWER IO
- POTABLE WATER CONNECTION

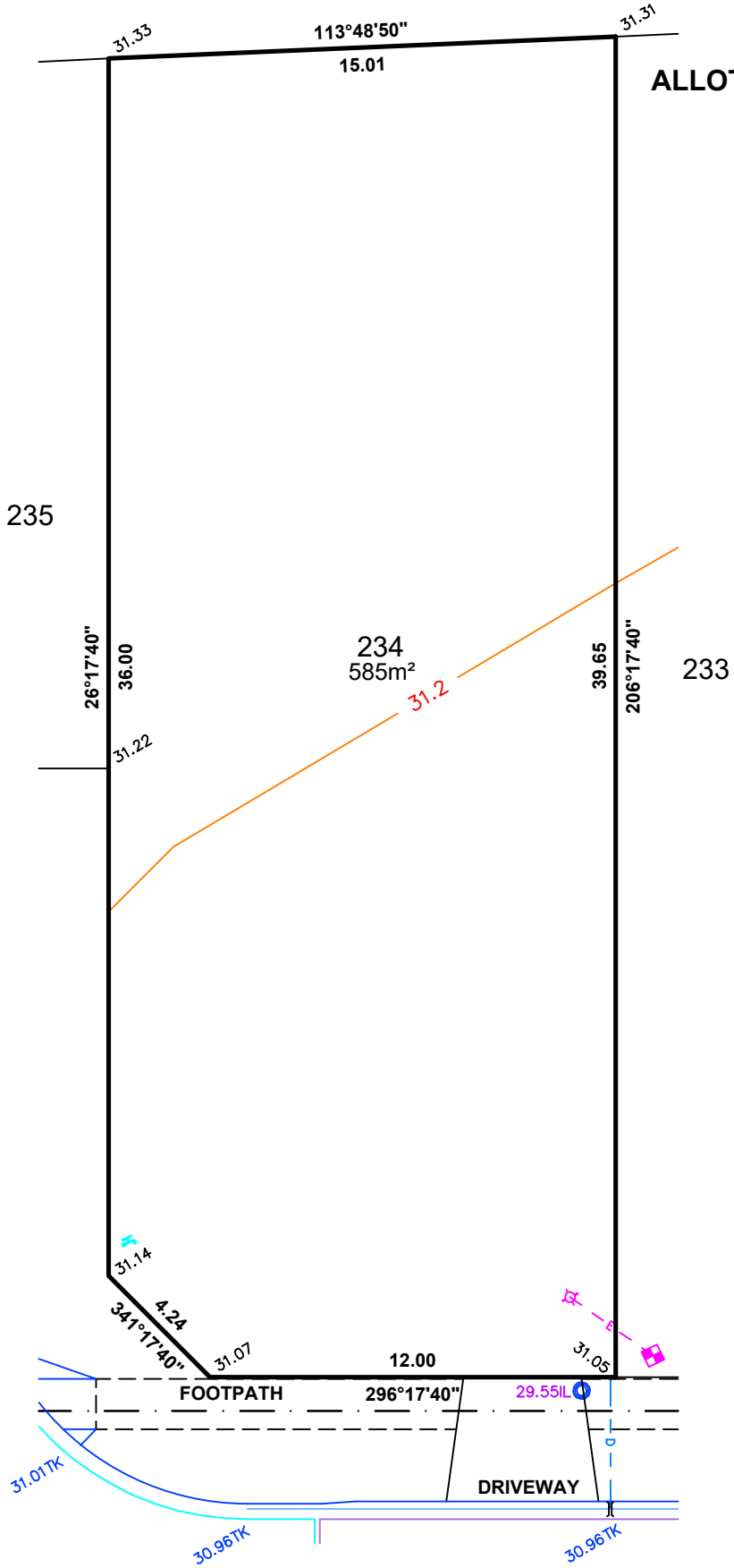

CANTINA ROAD



1:200

ALEXANDER SYMONDS
 PH 8130 1666

DISCLAIMER: DATA SHOWN HEREON IS DESIGN INFORMATION AND SHOULD BE CONFIRMED ORIGINAL SHEET SIZE A4

IMPORTANT
 SERVICE AND DRIVEWAY LOCATIONS
 ARE APPROXIMATE. ANY CHANGES WILL
 BE AT THE PURCHASERS EXPENSE.
 PURCHASER: _____
 PURCHASER: _____
 DATE: _____

DISCLAIMER:
 Please note that this site plan is intended for
 visual purposes only. Additional survey work will
 be required prior to commencing any design or
 construction on the site.

ALLOTMENT 235 in DEV. NO. 292/D029/20/001
 in the area named
ANGLE VALE
 CT ---/-----

PRELIMINARY

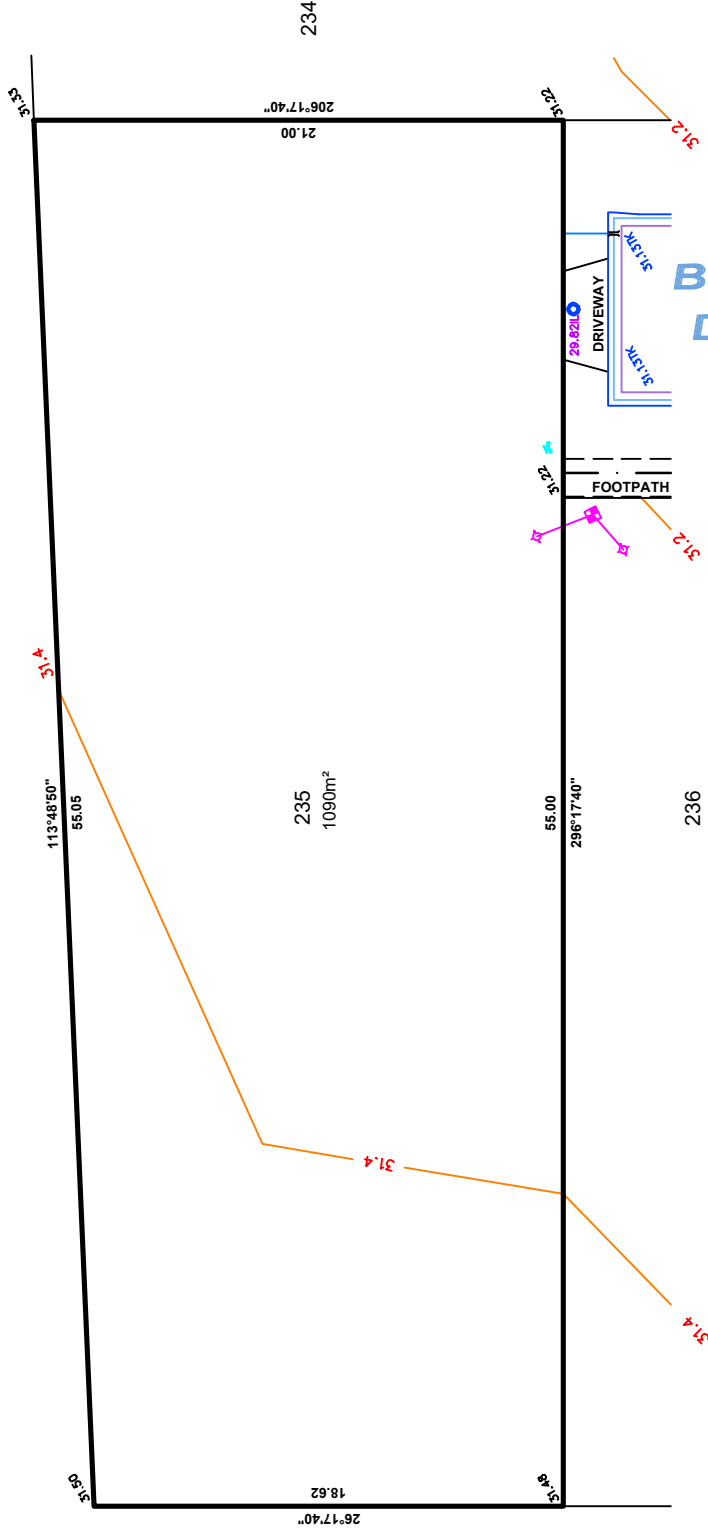
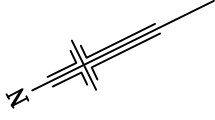

- LEGEND**
- INVERT LEVEL
 - ELECTRICAL LEAD IN
 - WATER METER
 - SEWER IP
 - STOBIE POLE
 - NBN PIT
 - STORMWATER GRATING
 - SEWER MANHOLE
 - STORMWATER MANHOLE
 - LIGHT POLE
 - SAPN CONNECTION
 - BOLLARD
 - SIGN
 - STORMWATER CONNECTION
 - FOOTPATH
 - SIDE ENTRY PIT (SEP)
 - COMMON SERVICE TRENCH
 - DOMESTIC OUTLET (STORMWATER)
 - SEWER IO
 - POTABLE WATER CONNECTION



1:300

ALEXANDER SYMONDS
 PH 8130 1666

DISCLAIMER: DATA SHOWN HEREON IS DESIGN INFORMATION AND SHOULD BE CONFIRMED
 ORIGINAL SHEET SIZE A4

ALLOTMENT 236 in DEV. NO. 292/D029/20/001

in the area named

ANGLE VALE

CT ---/---

PRELIMINARY

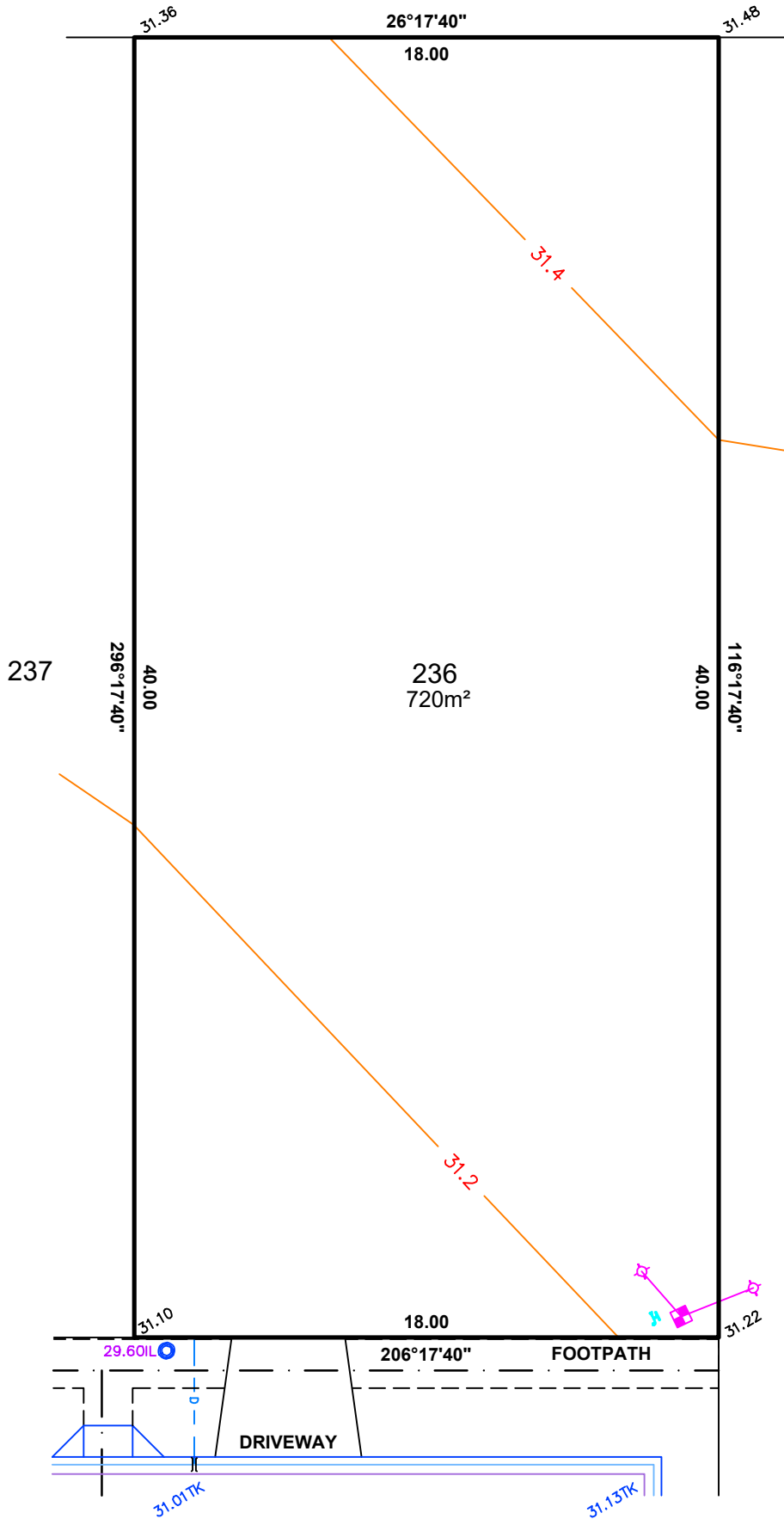
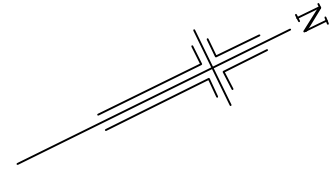

LEGEND

- 29.00IL INVERT LEVEL
- ⊕ ELECTRICAL LEAD IN
- ⊕ WATER METER
- ⊕ SEWER IP
- ▬ STOBIE POLE
- ▭ NBN PIT
- ▨ STORMWATER GRATING
- ⊙ SEWER MANHOLE
- ⊕ STORMWATER MANHOLE
- ⊕ LIGHT POLE
- ⊕ SAPN CONNECTION
- BOLLARD
- ♀ SIGN
- ⊕ STORMWATER CONNECTION
- - - FOOTPATH
- ▭ SIDE ENTRY PIT (SEP)
- - - COMMON SERVICE TRENCH
- - - DOMESTIC OUTLET (STORMWATER)
- ⊕ SEWER IO
- ⊕ POTABLE WATER CONNECTION

IMPORTANT
 SERVICE AND DRIVEWAY LOCATIONS
 ARE APPROXIMATE. ANY CHANGES WILL
 BE AT THE PURCHASERS EXPENSE.
 PURCHASER: _____
 PURCHASER: _____
 DATE: _____

DISCLAIMER:

Please note that this site plan is intended for visual purposes only, additional survey work will be required prior to commencing any design or construction on the site.

BACCA DRIVE



1:200

ALEXANDER SYMONDS
 PH 8130 1666

DISCLAIMER: DATA SHOWN HEREON IS DESIGN INFORMATION AND SHOULD BE CONFIRMED
 ORIGINAL SHEET SIZE A4

ALLOTMENT 237 in DEV. NO. 292/D029/20/001

in the area named

ANGLE VALE

CT ---/---

PRELIMINARY

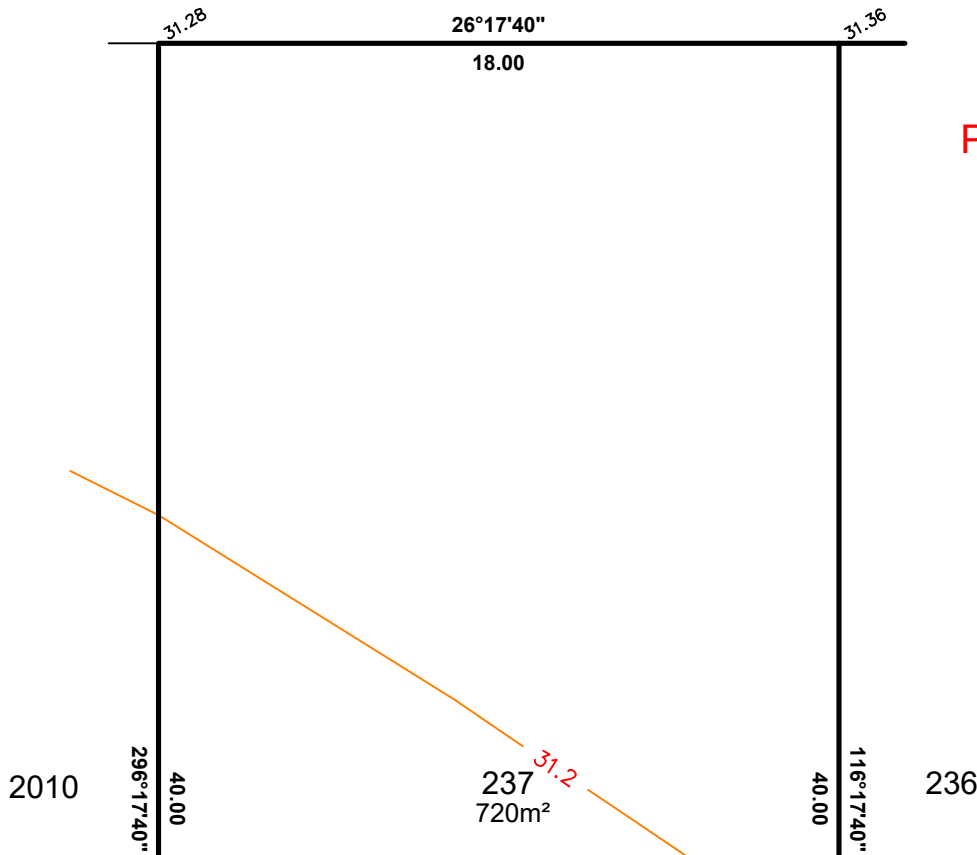
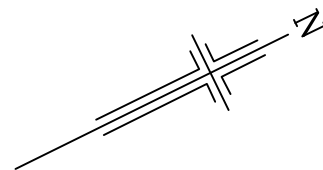

- LEGEND**
- 29.00IL INVERT LEVEL
 - ✦ ELECTRICAL LEAD IN
 - ⊕ WATER METER
 - ⊙ SEWER IP
 - ⊥ STOBIE POLE
 - NBN PIT
 - ▨ STORMWATER GRATING
 - ⊙ SEWER MANHOLE
 - ⊠ STORMWATER MANHOLE
 - ✦ LIGHT POLE
 - ⊠ SAPN CONNECTION
 - BOLLARD
 - ♀ SIGN
 - ⊙ STORMWATER CONNECTION
 - - - FOOTPATH
 - ▭ SIDE ENTRY PIT (SEP)
 - - - COMMON SERVICE TRENCH
 - - - D DOMESTIC OUTLET (STORMWATER)
 - ⊙ SEWER IO
 - ⊕ POTABLE WATER CONNECTION

IMPORTANT
 SERVICE AND DRIVEWAY LOCATIONS
 ARE APPROXIMATE. ANY CHANGES WILL
 BE AT THE PURCHASERS EXPENSE.
 PURCHASER: _____
 PURCHASER: _____
 DATE: _____

DISCLAIMER:

Please note that this site plan is intended for visual purposes only, additional survey work will be required prior to commencing any design or construction on the site.

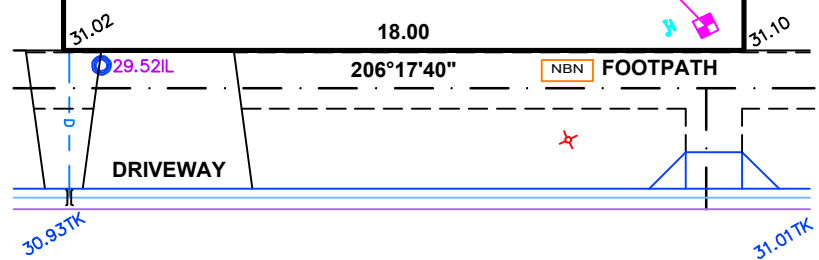

BACCA DRIVE



1:200

ALLOTMENT 238 in DEV. NO. 292/D029/20/001

in the area named

ANGLE VALE

CT ---/---

PRELIMINARY

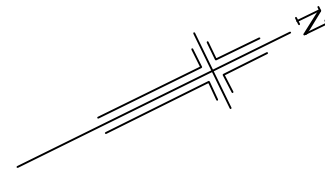

239

238
600m²

237

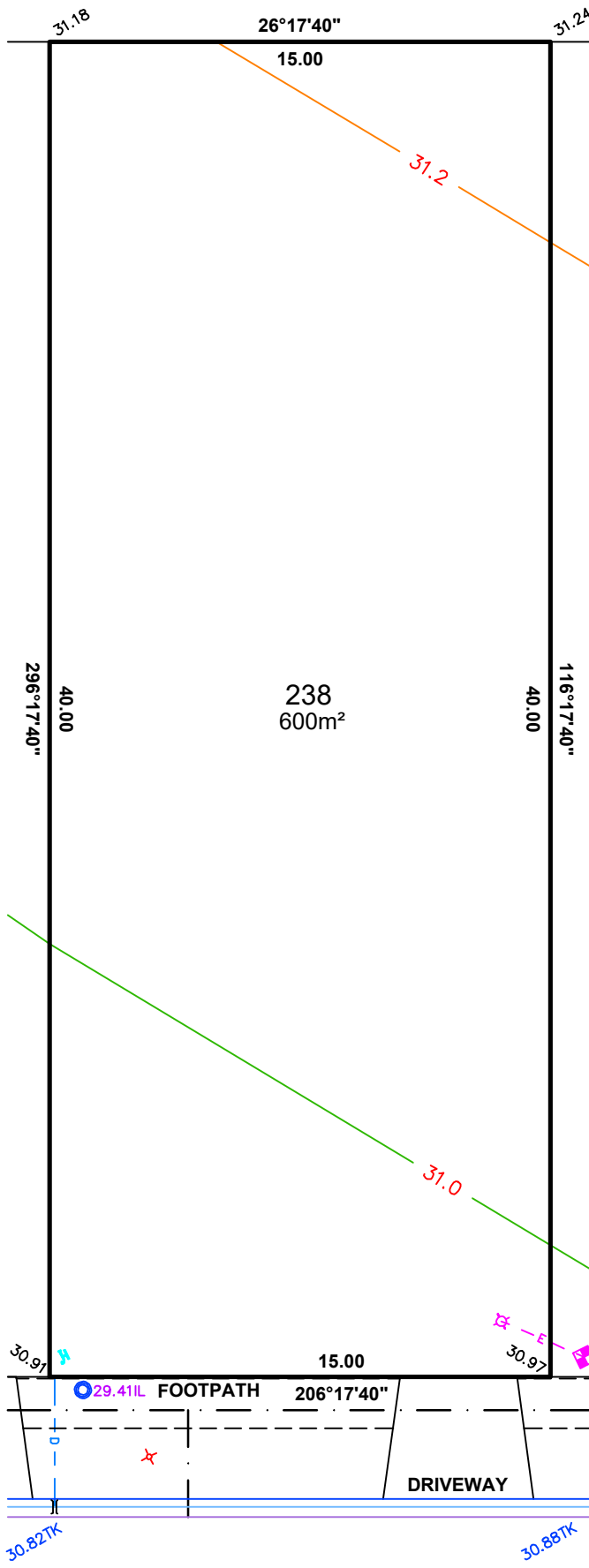

LEGEND

- 29.00IL INVERT LEVEL
- ✦ ELECTRICAL LEAD IN
- ⊕ WATER METER
- ⊙ SEWER IP
- ⊥ STOBIE POLE
- NBN PIT
- ▨ STORMWATER GRATING
- ⊙ SEWER MANHOLE
- ⊠ STORMWATER MANHOLE
- ✦ LIGHT POLE
- ⊠ SAPN CONNECTION
- BOLLARD
- ♀ SIGN
- ⊕ STORMWATER CONNECTION
- - - FOOTPATH
- ▭ SIDE ENTRY PIT (SEP)
- - - COMMON SERVICE TRENCH
- - - D DOMESTIC OUTLET (STORMWATER)
- ⊙ SEWER IO
- ⊕ POTABLE WATER CONNECTION

IMPORTANT
 SERVICE AND DRIVEWAY LOCATIONS
 ARE APPROXIMATE. ANY CHANGES WILL
 BE AT THE PURCHASERS EXPENSE.
 PURCHASER: _____
 PURCHASER: _____
 DATE: _____

DISCLAIMER:

Please note that this site plan is intended for visual purposes only, additional survey work will be required prior to commencing any design or construction on the site.

BACCA DRIVE



1:200

PRELIMINARY

IMPORTANT
 SERVICE AND DRIVEWAY LOCATIONS
 ARE APPROXIMATE. ANY CHANGES WILL
 BE AT THE PURCHASERS EXPENSE.
 PURCHASER: _____
 PURCHASER: _____
 DATE: _____

DISCLAIMER:

Please note that this site plan is intended for
 visual purposes only, additional survey work will
 be required prior to commencing any design or
 construction on the site.

CANTINA ROAD

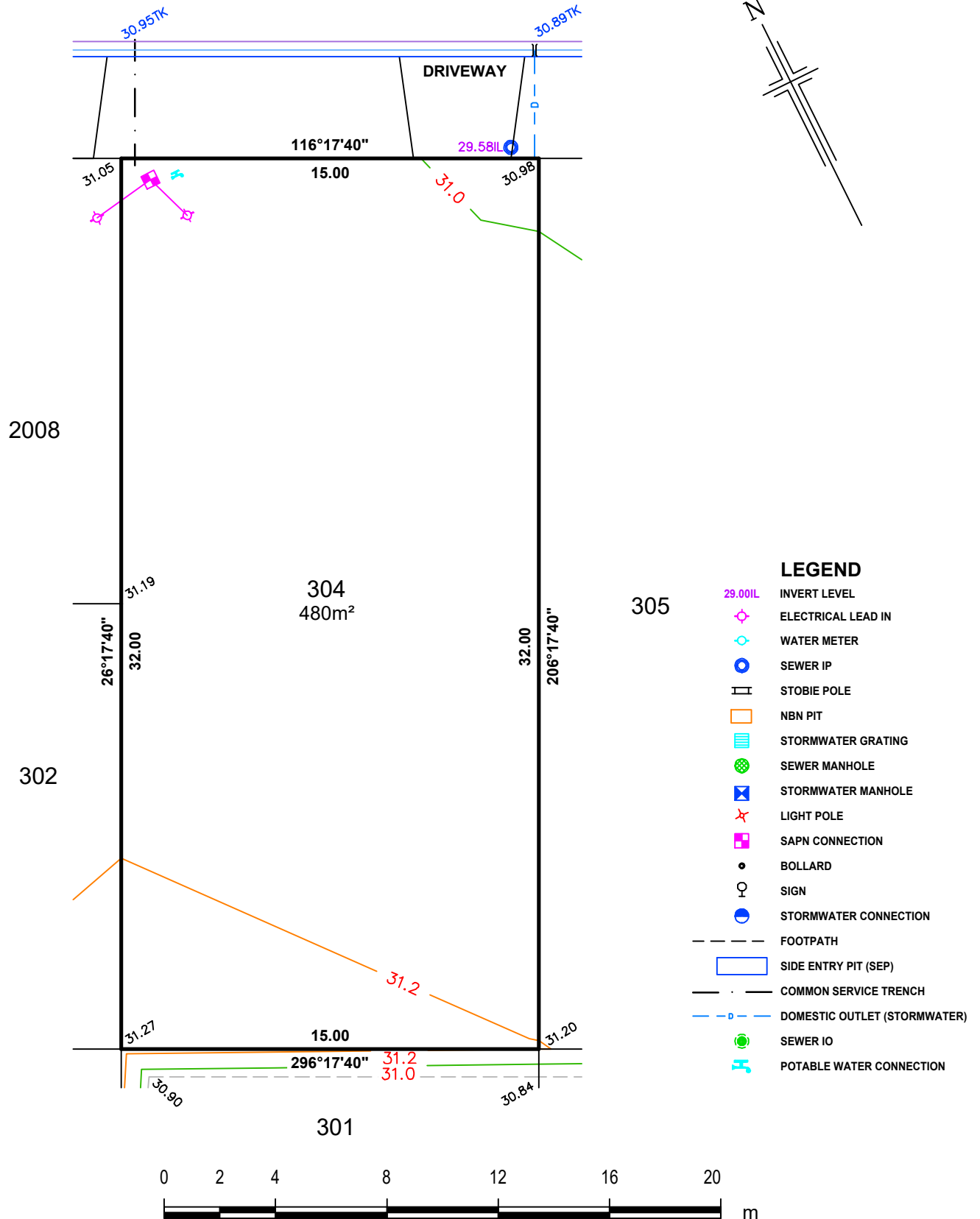

PRELIMINARY

IMPORTANT
 SERVICE AND DRIVEWAY LOCATIONS
 ARE APPROXIMATE. ANY CHANGES WILL
 BE AT THE PURCHASERS EXPENSE.
 PURCHASER: _____
 PURCHASER: _____
 DATE: _____

DISCLAIMER:

Please note that this site plan is intended for
 visual purposes only, additional survey work will
 be required prior to commencing any design or
 construction on the site.

CANTINA ROAD

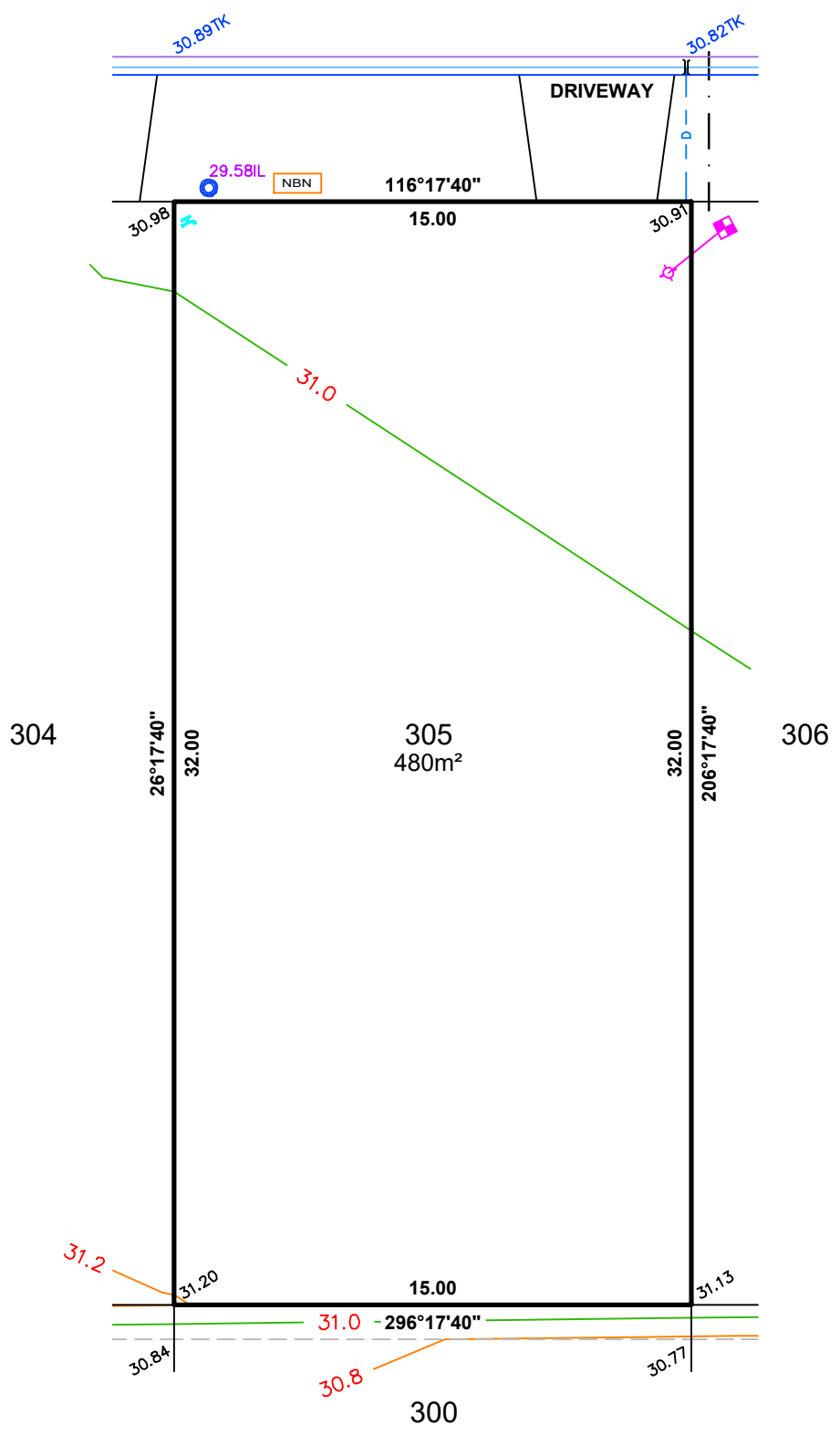
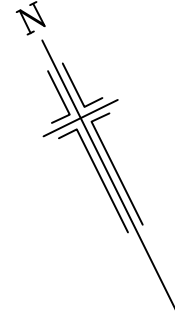

- LEGEND**
- 29.00IL INVERT LEVEL
 - ⊕ ELECTRICAL LEAD IN
 - ⊕ WATER METER
 - SEWER IP
 - STOBIE POLE
 - NBN PIT
 - STORMWATER GRATING
 - SEWER MANHOLE
 - STORMWATER MANHOLE
 - ✕ LIGHT POLE
 - ⊕ SAPN CONNECTION
 - BOLLARD
 - ♀ SIGN
 - STORMWATER CONNECTION
 - FOOTPATH
 - SIDE ENTRY PIT (SEP)
 - COMMON SERVICE TRENCH
 - - - - - DOMESTIC OUTLET (STORMWATER)
 - SEWER IO
 - ⊕ POTABLE WATER CONNECTION



1:200

PRELIMINARY

IMPORTANT
 SERVICE AND DRIVEWAY LOCATIONS
 ARE APPROXIMATE. ANY CHANGES WILL
 BE AT THE PURCHASERS EXPENSE.
 PURCHASER: _____
 PURCHASER: _____
 DATE: _____

DISCLAIMER:

Please note that this site plan is intended for
 visual purposes only, additional survey work will
 be required prior to commencing any design or
 construction on the site.

CANTINA ROAD

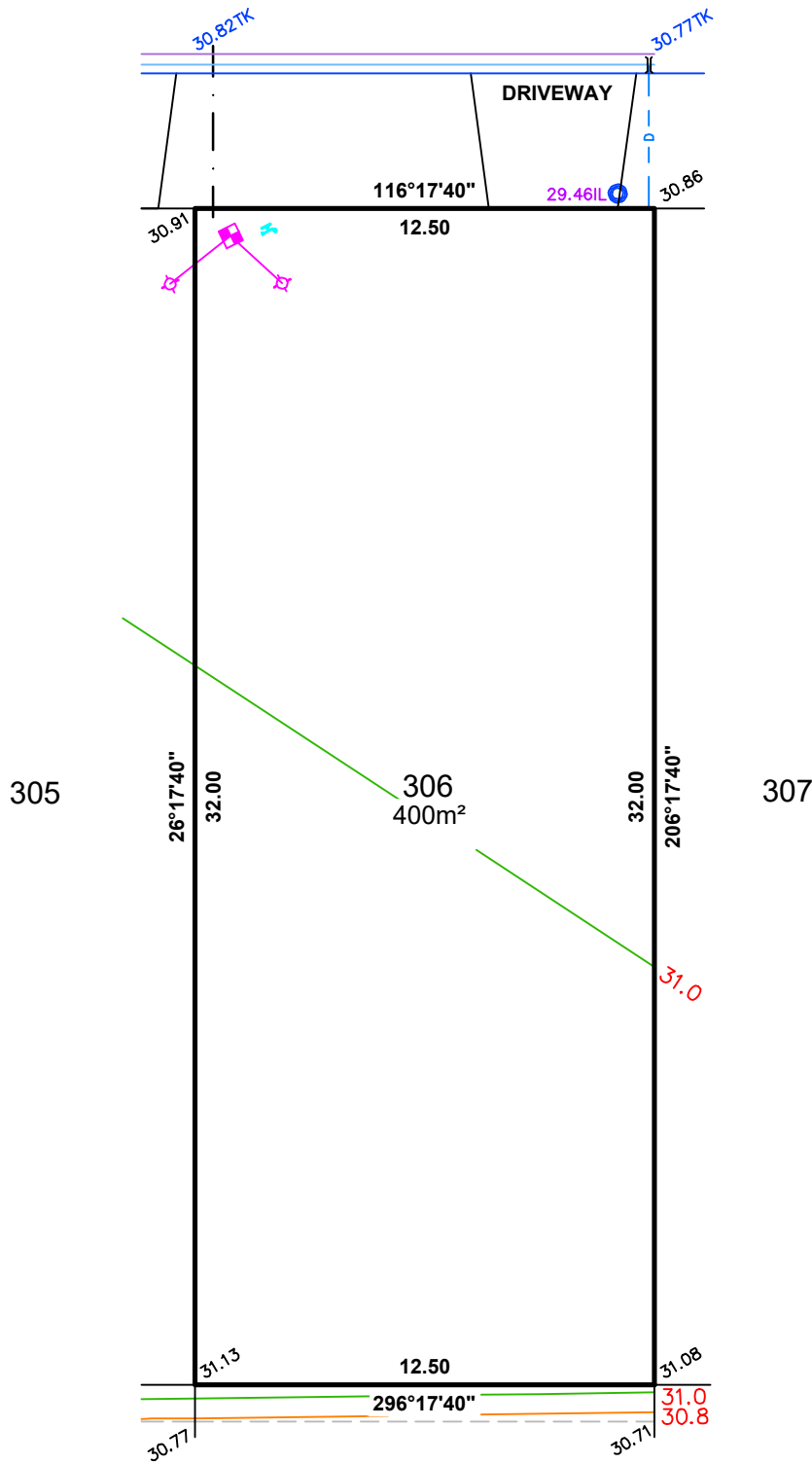
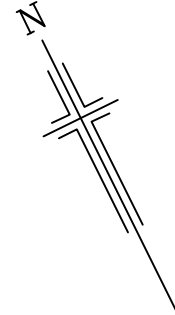

- LEGEND**
- 29.00L INVERT LEVEL
 - ⊕ ELECTRICAL LEAD IN
 - ⊕ WATER METER
 - ⊕ SEWER IP
 - ⊕ STOBIE POLE
 - ⊕ NBN PIT
 - ⊕ STORMWATER GRATING
 - ⊕ SEWER MANHOLE
 - ⊕ STORMWATER MANHOLE
 - ⊕ LIGHT POLE
 - ⊕ SAPN CONNECTION
 - ⊕ BOLLARD
 - ⊕ SIGN
 - ⊕ STORMWATER CONNECTION
 - FOOTPATH
 - ⊕ SIDE ENTRY PIT (SEP)
 - COMMON SERVICE TRENCH
 - DOMESTIC OUTLET (STORMWATER)
 - ⊕ SEWER IO
 - ⊕ POTABLE WATER CONNECTION

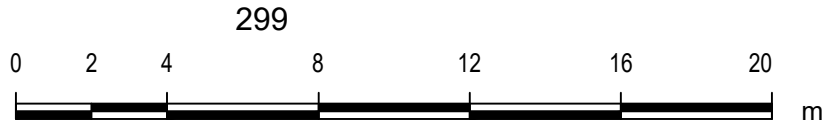

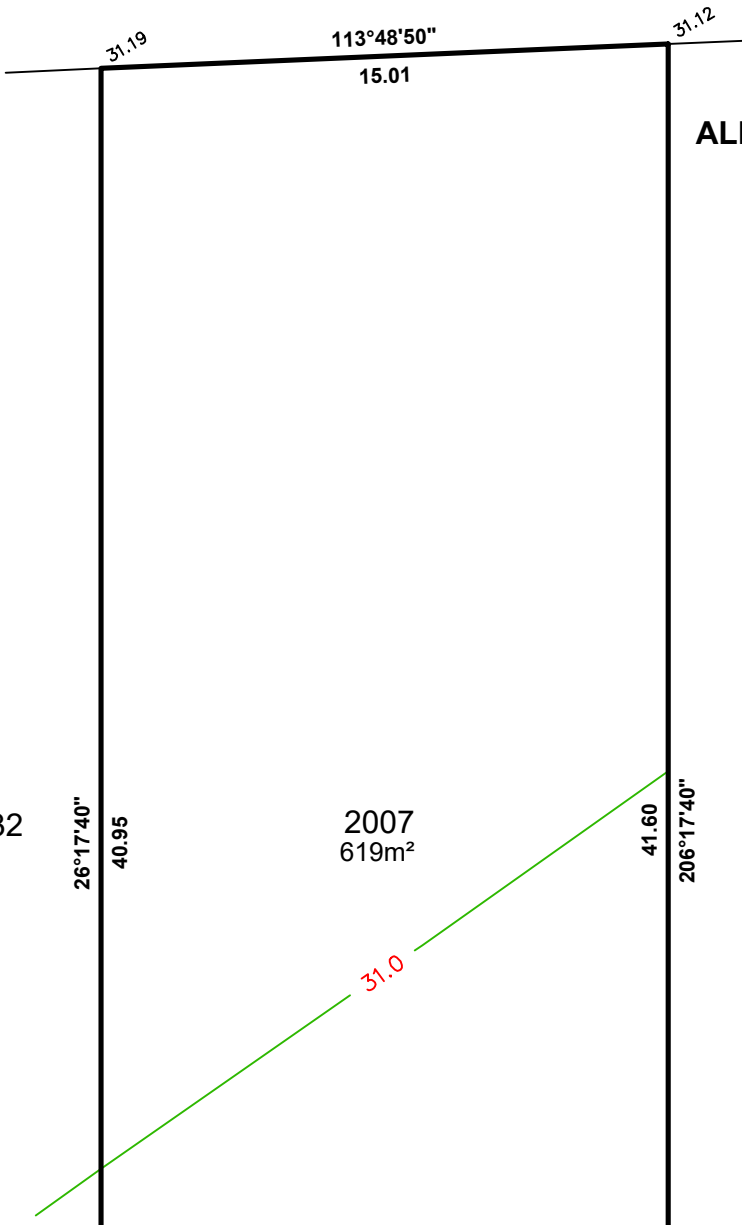

ALLOTMENT 2007 in DEV. NO. 292/D029/20/001
 in the area named
ANGLE VALE
 CT ---/----

PRELIMINARY

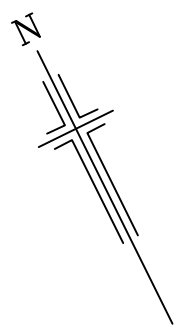

IMPORTANT
 SERVICE AND DRIVEWAY LOCATIONS
 ARE APPROXIMATE. ANY CHANGES WILL
 BE AT THE PURCHASERS EXPENSE.
 PURCHASER: _____
 PURCHASER: _____
 DATE: _____

DISCLAIMER:

Please note that this site plan is intended for visual purposes only, additional survey work will be required prior to commencing any design or construction on the site.

LEGEND

- 29.00IL INVERT LEVEL
- ⊕ ELECTRICAL LEAD IN
- ⊕ WATER METER
- ⊙ SEWER IP
- ▬ STOBIE POLE
- NBN PIT
- ▬ STORMWATER GRATING
- ⊙ SEWER MANHOLE
- ⊕ STORMWATER MANHOLE
- ★ LIGHT POLE
- ⊕ SAPN CONNECTION
- BOLLARD
- ♀ SIGN
- ⊙ STORMWATER CONNECTION
- - - FOOTPATH
- ▭ SIDE ENTRY PIT (SEP)
- - - COMMON SERVICE TRENCH
- - - DOMESTIC OUTLET (STORMWATER)
- ⊙ SEWER IO
- ⊕ POTABLE WATER CONNECTION

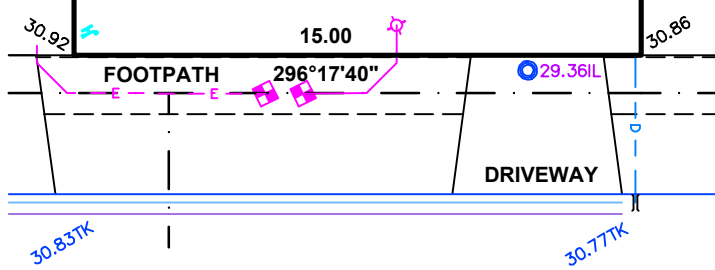

CANTINA ROAD



1:200

ALEXANDER SYMONDS
 PH 8130 1666

DISCLAIMER: DATA SHOWN HEREON IS DESIGN INFORMATION AND SHOULD BE CONFIRMED
 ORIGINAL SHEET SIZE A4

ALLOTMENT 2010 in DEV. NO. 292/D029/20/001

in the area named

ANGLE VALE

CT ---/---

PRELIMINARY

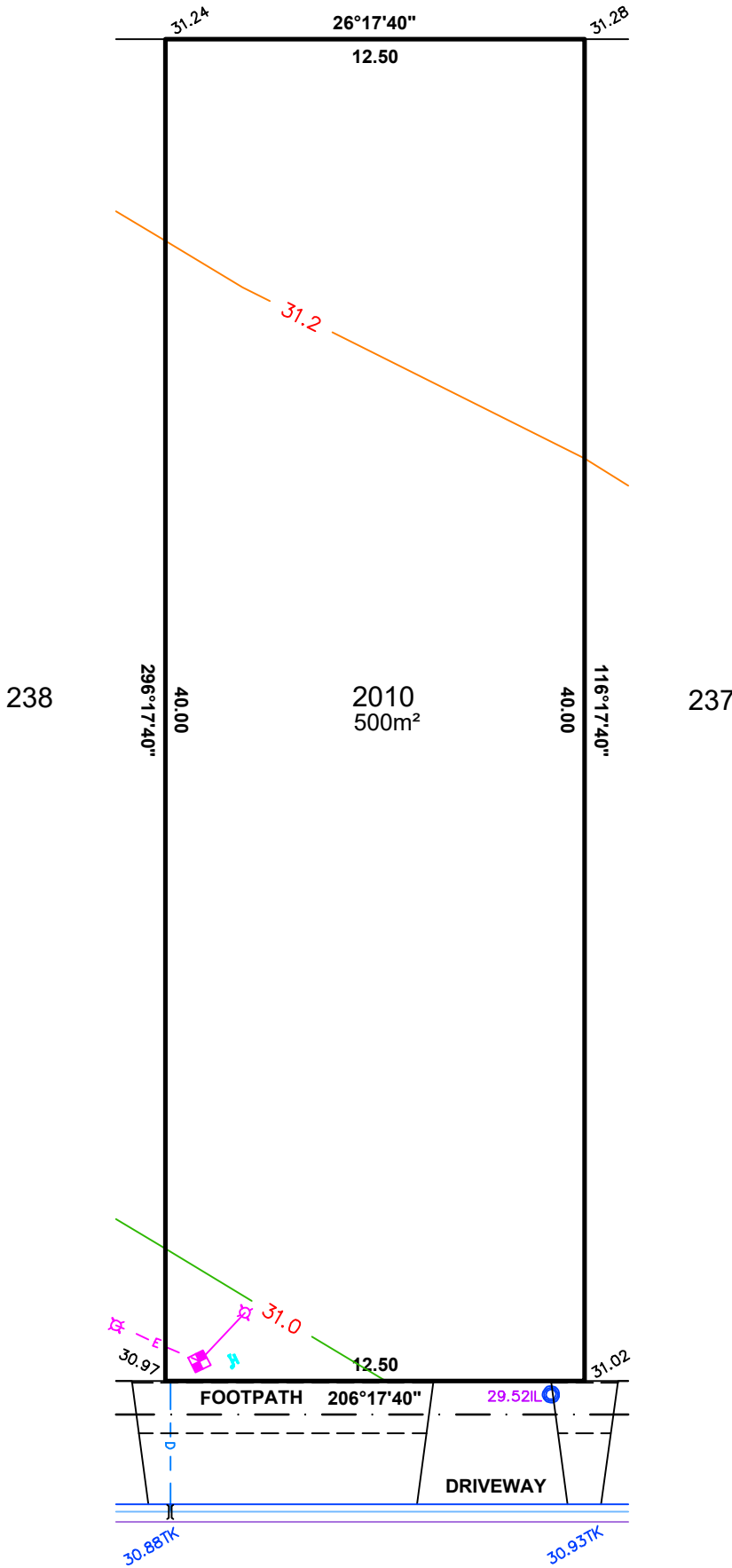
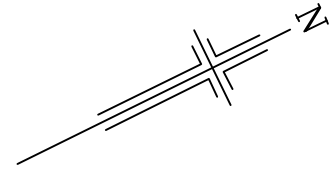

LEGEND

- 29.00IL INVERT LEVEL
- Electrical symbol ELECTRICAL LEAD IN
- Water meter symbol WATER METER
- Blue circle symbol SEWER IP
- Vertical line symbol STOBIE POLE
- Orange rectangle symbol NBN PIT
- Blue hatched rectangle symbol STORMWATER GRATING
- Green circle with dots symbol SEWER MANHOLE
- Blue square with X symbol STORMWATER MANHOLE
- Red star symbol LIGHT POLE
- Purple square symbol SAPN CONNECTION
- Black dot symbol BOLLARD
- Circle with vertical line symbol SIGN
- Blue circle with horizontal line symbol STORMWATER CONNECTION
- Dashed line symbol FOOTPATH
- Blue rectangle symbol SIDE ENTRY PIT (SEP)
- Black line symbol COMMON SERVICE TRENCH
- Blue dashed line with 'D' symbol DOMESTIC OUTLET (STORMWATER)
- Green circle with 'S' symbol SEWER IO
- Blue T-shaped symbol POTABLE WATER CONNECTION

IMPORTANT
 SERVICE AND DRIVEWAY LOCATIONS ARE APPROXIMATE. ANY CHANGES WILL BE AT THE PURCHASERS EXPENSE.
 PURCHASER: _____
 PURCHASER: _____
 DATE: _____

DISCLAIMER:

Please note that this site plan is intended for visual purposes only, additional survey work will be required prior to commencing any design or construction on the site.

BACCA DRIVE



1:200